



Lane

Street

REAR YARD SETBACK
15.73m [51'-7"]

FRONT YARD SETBACK
6.10m [20'-0"]

0.41m [1'-4"]

1'-8 9/16"

Property Line

GARAGE
16' x 8' OVERHEAD DOOR

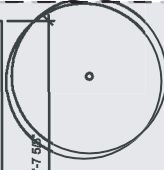

24'-7 9/16"

2.45m [8'-0"]
SIDE YD. SETBACK

3.71m [12'-2"]
SIDE YD. SETBACK

40'-6 7/16"

8'-5 1/8"

24'-7 1/8"

REAR YARD SETBACK

19.55m [64'-2"]

Property Line

FRONT YARD SETBACK
5.13m [16'-10"]

3.66m [12'-0"]
SIDE YD. SETBACK

REAR YARD SETBACK

18.10m [59'-4"]

GARAGE

Property Line

1.03m [3'-4"]
SIDE YD. SETBACK

3.91m [12'-10"]
SIDE YD. SETBACK

0.61m [2'-0"]
SIDE YD. SETBACK

REAR YARD SETBACK
6.05m [19'-10"]

SIDE YD. SETBACK