

20.11a

Nova Scotia Home Remodel - Existing Plan
SLOW HOME STUDIO ONLINE WORKSHOP

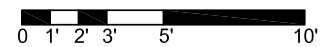

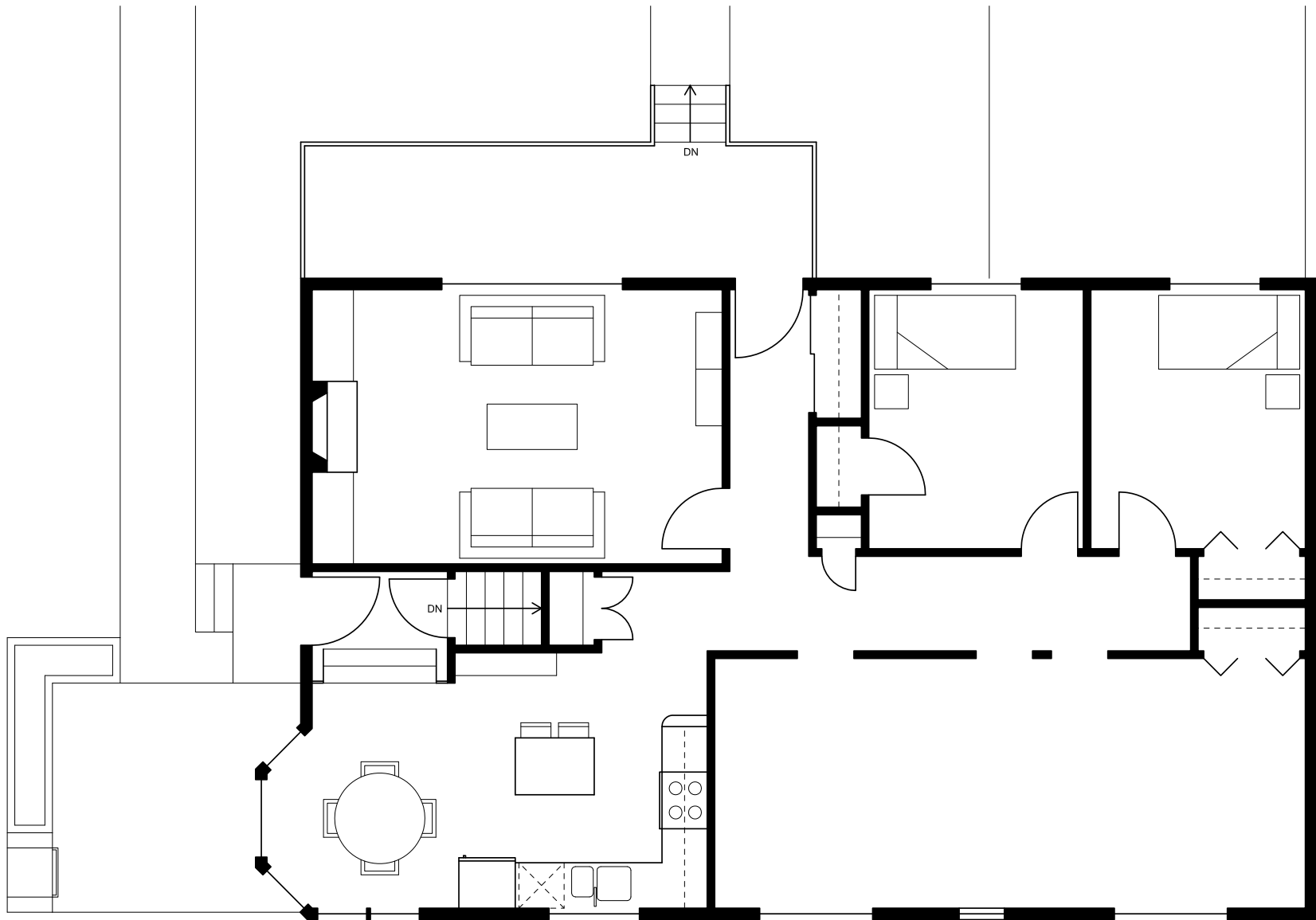

20.11b

Nova Scotia Home Remodel - Demolition Plan
SLOW HOME STUDIO ONLINE WORKSHOP

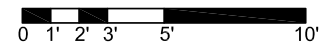

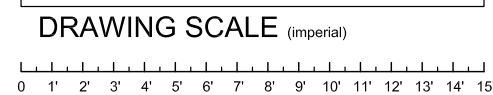
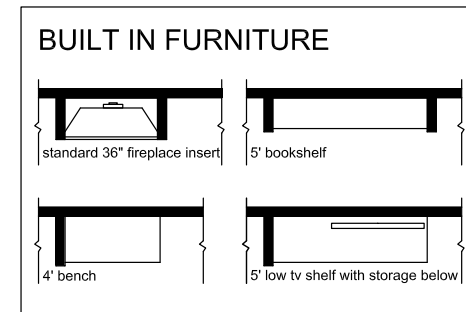
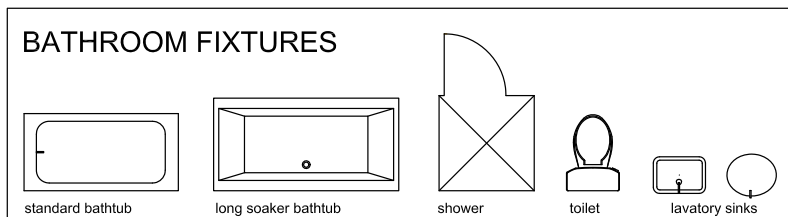
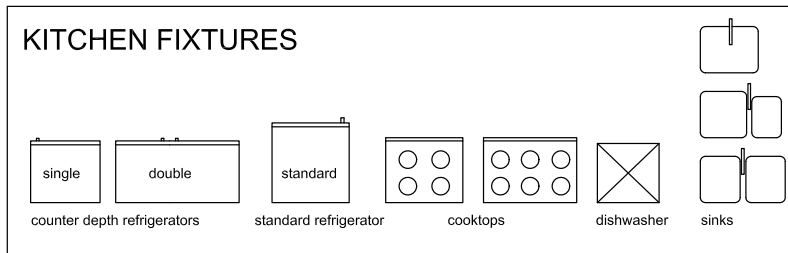
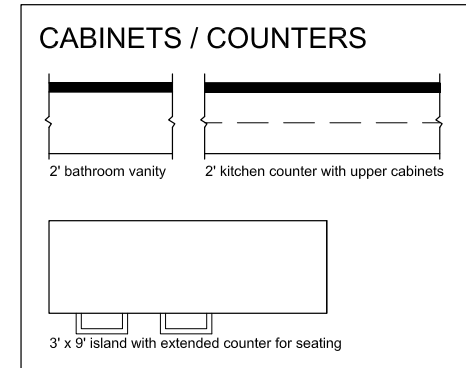
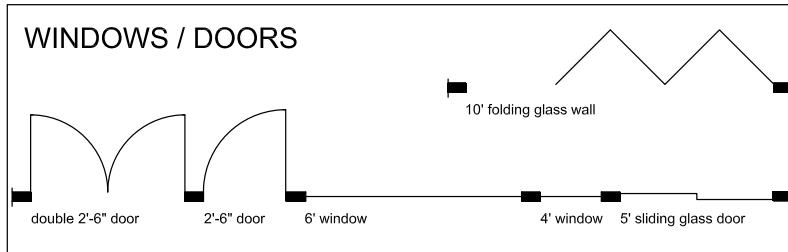

This sheet contains templates of the standard elements of residential construction. They are at the same scale as the plan documents for this project. Use them as a guide when working on the exercise by tracing the required elements into your concept design. Feel free to re-size the length of the windows, built-ins, cabinets and counter elements to suit your specific needs.

Please note that this template has been scaled for use with this exercise. As the plans in each project are scaled to fit the page, be sure to always use the template provided with the particular project you are working on.

TABLES

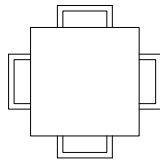

39" x 39"

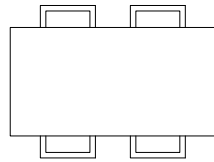

39" x 75"

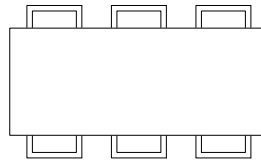

39" x 84"

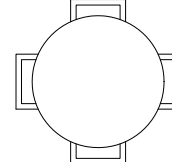

48"

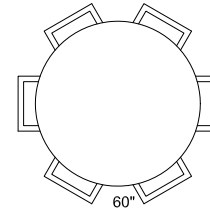

60"

SEATING

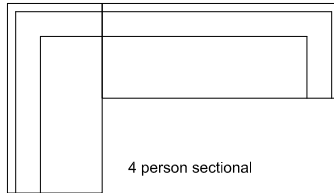

4 person sectional

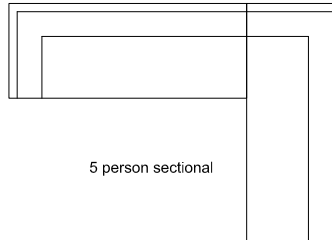

5 person sectional

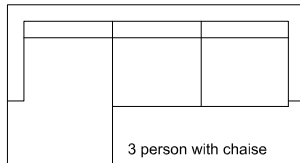

3 person with chaise

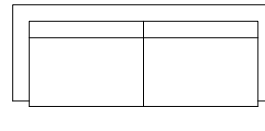

3 person

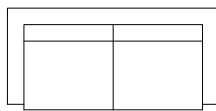

2 person

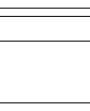

chairs

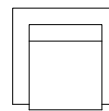

BEDS

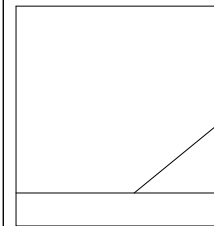

King

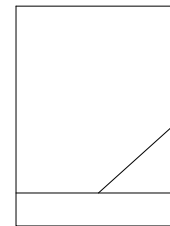

Queen

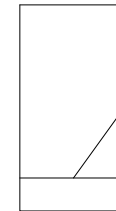

Single

MISCELLANEOUS



side tables



48" dresser drawer



72" bookshelf



coffee tables



60" desk

This sheet contains templates of typical residential furniture pieces. They are at the same scale as the plan documents for this project. Use them as a guide when working on the exercise by tracing the required elements into your concept design. Please note that this template has been scaled for use with this exercise. As the plans in each project are scaled to fit the page, be sure to always use the template provided with the particular project you are working on.